

GWAL-CSK Countersunk Threaded Insert

Aluminium · Countersunk · Round · Open end
M3 - M10

Features

- Designed to provide load bearing threads in thin sheet materials
- Countersunk head flush installation and clamp up

Material

- Aluminium 5052

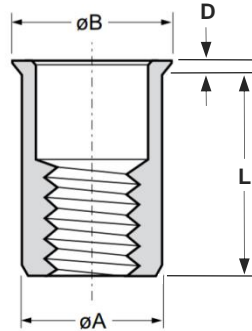

Before Placement

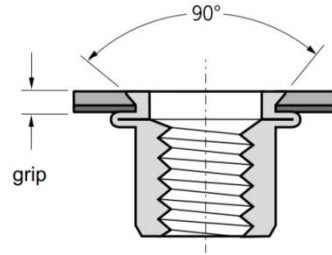

After Placement

Part No.	Thread Size	Grip Range		Hole Size	øA	øB	D	L
		min.	max.	+0.1	-0.02/-0.15	0 / -0.5	0 / +0.3	±0.35
GWAL-CSKM3-1735	M3	1.7	3.5	5.0	5.0	8.0	1.5	11.25
GWAL-CSKM4-1735	M4	1.7	3.5	6.0	6.0	9.0	1.5	11.5
GWAL-CSKM4-3550		3.5	5.0					13.0
GWAL-CSKM5-1740	M5	1.7	4.0	7.0	7.0	10.0	1.5	13.0
GWAL-CSKM5-4065		4.0	6.5					16.0
GWAL-CSKM6-1745	M6	1.7	4.5	9.0	9.0	12.0	1.5	17.0
GWAL-CSKM6-4565		4.5	6.5					19.0
GWAL-CSKM8-1745	M8	1.7	4.5	11.0	11.0	14.0	1.5	19.0
GWAL-CSKM8-4565		4.5	6.5					21.0
GWAL-CSKM10-1745	M10	1.7	4.5	12.5	12.4	15.4	1.5	21.0
GWAL-CSKM10-4565		4.5	6.5					23.0

Thread Size	Max. torque	Pull-out	Torque-to-turn	Shear strength
	Nm max.	Kn	Nm	kN
M3	~1.9	> ~3.1	~0.8	~0.6
M4	~4.9	> ~4.5	~1.4	~1.1
M5	~4.9	> ~5.2	~1.5	~1.6
M6	~16.0	> ~10.5	~3.2	~2.4
M8	~33.0	> ~15.0	~5.3	~2.9
M10	~39.5	> ~20.0	~7.0	~3.7